

Advance warning sign
 A/W
 If requested, signs to be positioned in suitable locations 1 week prior to work start date

Works area

Work starts here
 XX XXX

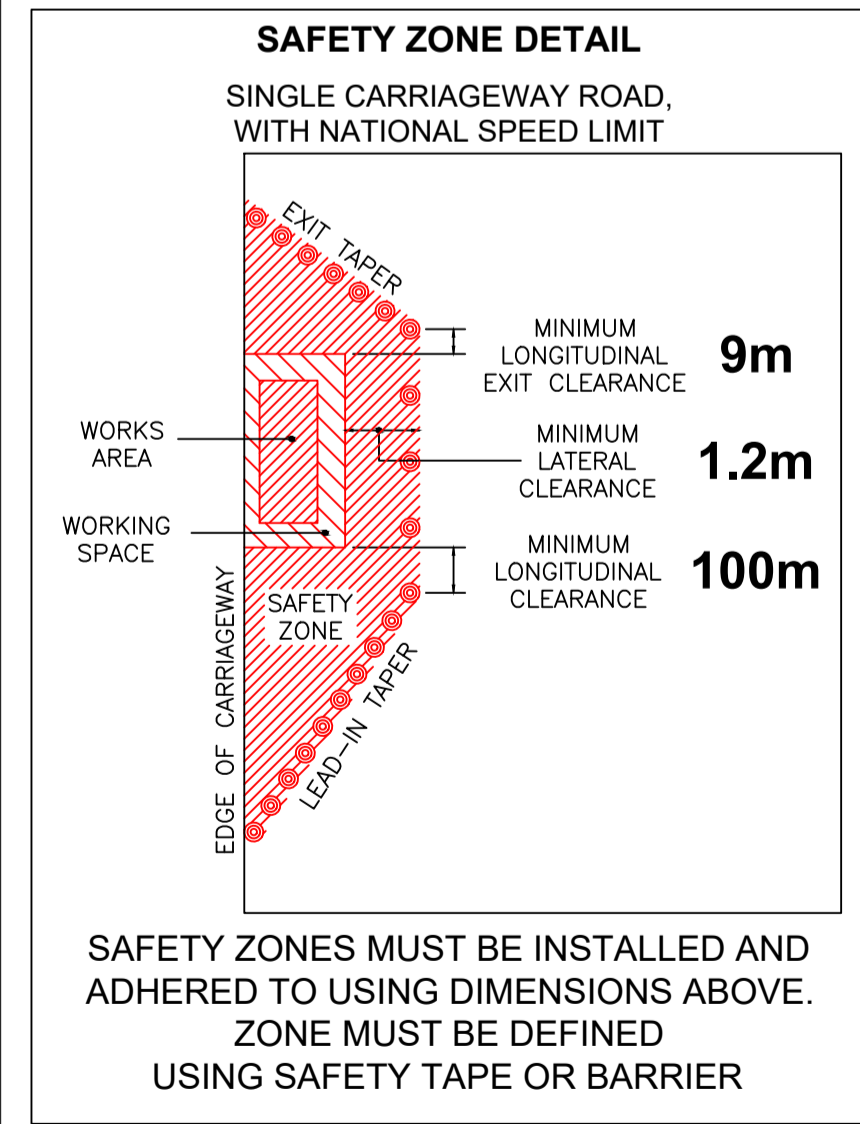
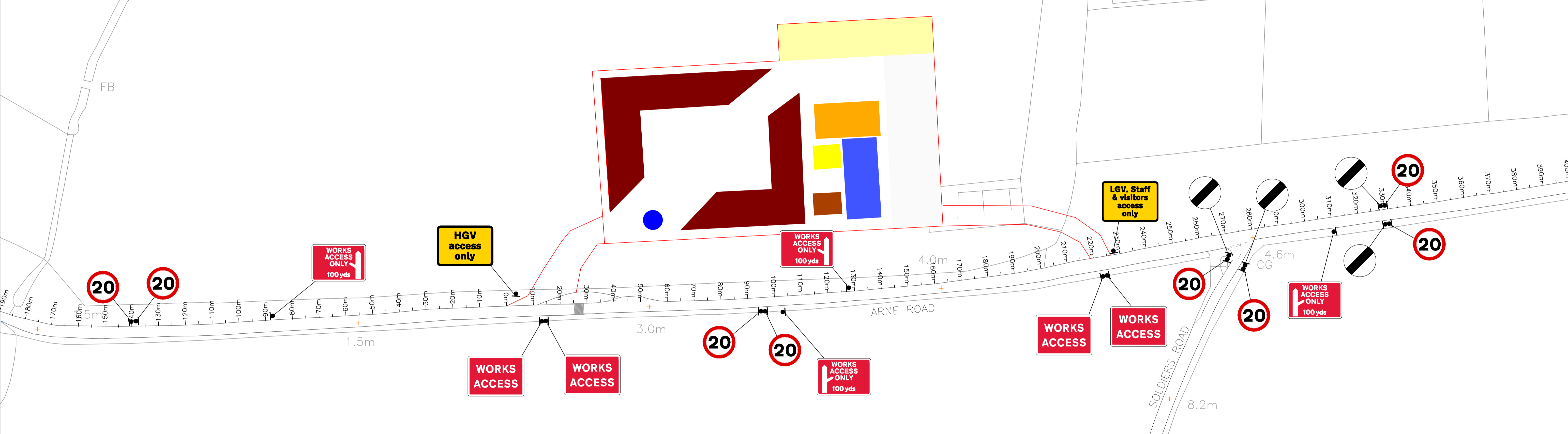

Site compound key

- Materials laydown
- Wheel / vehicle wash
- Outside break area
- Temp power / battery / PV cells
- Foul tank
- Site welfare & office units
- Batching plant
- Car park - capacity 40

Qty: 1 Ref: 13.9 Schedule 13-9 : Temporary Information	HGV access only
Qty: 1 Ref: 13.9 Schedule 13-9 : Temporary Information	LGV, Staff & visitors access only
Qty: 8 Ref: 670 20 mph maximum speed limit	20
Qty: 4 Ref: 671 National speed limit applies	
Qty: 4 Ref: 7301 Works access	WORKS ACCESS
Qty: 2 Ref: 7306 Route for works traffic ahead access only direction right reversible	WORKS ACCESS ONLY 100 yds
Qty: 2 Ref: 7306 Route for works traffic ahead access only direction left reversible	WORKS ACCESS ONLY 100 yds

Drm:	RM	 Forest Traffic Signals Ltd, FT House, Moorside Road Winnall, Winchester. SO23 7RX Tel: 01962 855351 Fax: 01962 855361						
Chk:	DC							
App:	LM							
Date:	07/02/2023							
			A	RM	JL	LM	REDUCED SPEED LIMIT TTRO TO 20MPH	14/02/23
			Rev.	Drm.	Chk.	App.	Description	Date.

Client:

Project:
 ARNE ROAD RIDGE WAREHAM
 BH20 5BU

Drawing:
 WORKS ACCESS WITH 30MPH TEMPORARY SPEED LIMIT

Drawing no:
 SWKI02-0056 -TMA01

Revision: A

Scale: NTS

Office copy	Issued to site	Issued to client
-------------	----------------	------------------